



ASSEMBLY INSTRUCTIONS

8400 SERIES TRACK

Pinch Pleated Draperies Configured as a Panel

Cut track to length and insert one end cap. Next, insert the baton master using a left hand baton master if you want the drapery to stack on the left side of the window (the left hand baton master is illustrated above). If you want the drapery to stack on the right side of the window, use the right hand master. After selecting and inserting the master carrier, insert all ball bearing carriers and the last end cap. Hold the entire track system up to the ceiling and attach with screws through the lip molded to the back side of the tracking system. Hang draperies and check to ensure smooth operation.

For smoother operation, lightly spray the inside of the track with an aerosol silicone lubricant. Depending upon environment, clean and re-lubricate as necessary.

Pinch Pleated Draperies Configured as a Pair

Cut track to length and insert one end cap. Next, half of the ball bearing carriers, the right hand baton master, the left hand baton master, the remaining ball bearing carriers, and the last end cap. Hold the entire track system up to the ceiling and attach with screws through the lip molded to the back side of the tracking system. Hang draperies and check to ensure smooth operation.

For smoother operation, lightly spray the inside of the track with an aerosol silicone lubricant. Depending upon environment, clean and re-lubricate as necessary.

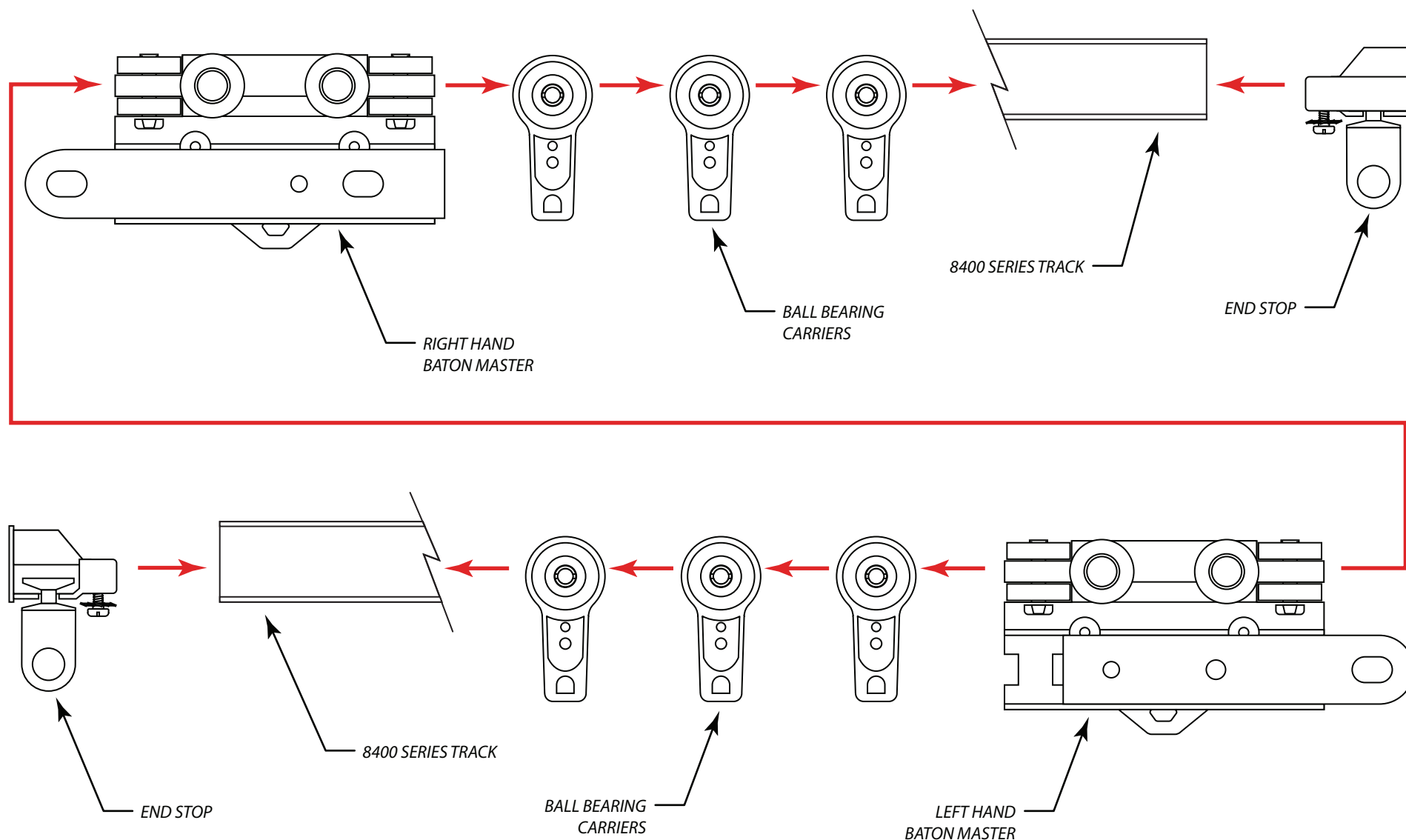

CONFIDENTIAL All materials disclosed in this document are proprietary to Diamond Drapery Co., Inc. The Holder agrees to maintain it in confidence and must not replicate or reveal this information in any manner.	Project: 8400 Series Drapery Tracking System Pinch Pleat, Pair	
	Date: 22-DEC-2008	Dimensions: Inches/Feet
	Scale: DO NOT SCALE	By: C. Johnson



7439 Lampson Avenue
Garden Grove, CA 92841
(714) 761-4543 OFFICE (714) 761-4623 FAX

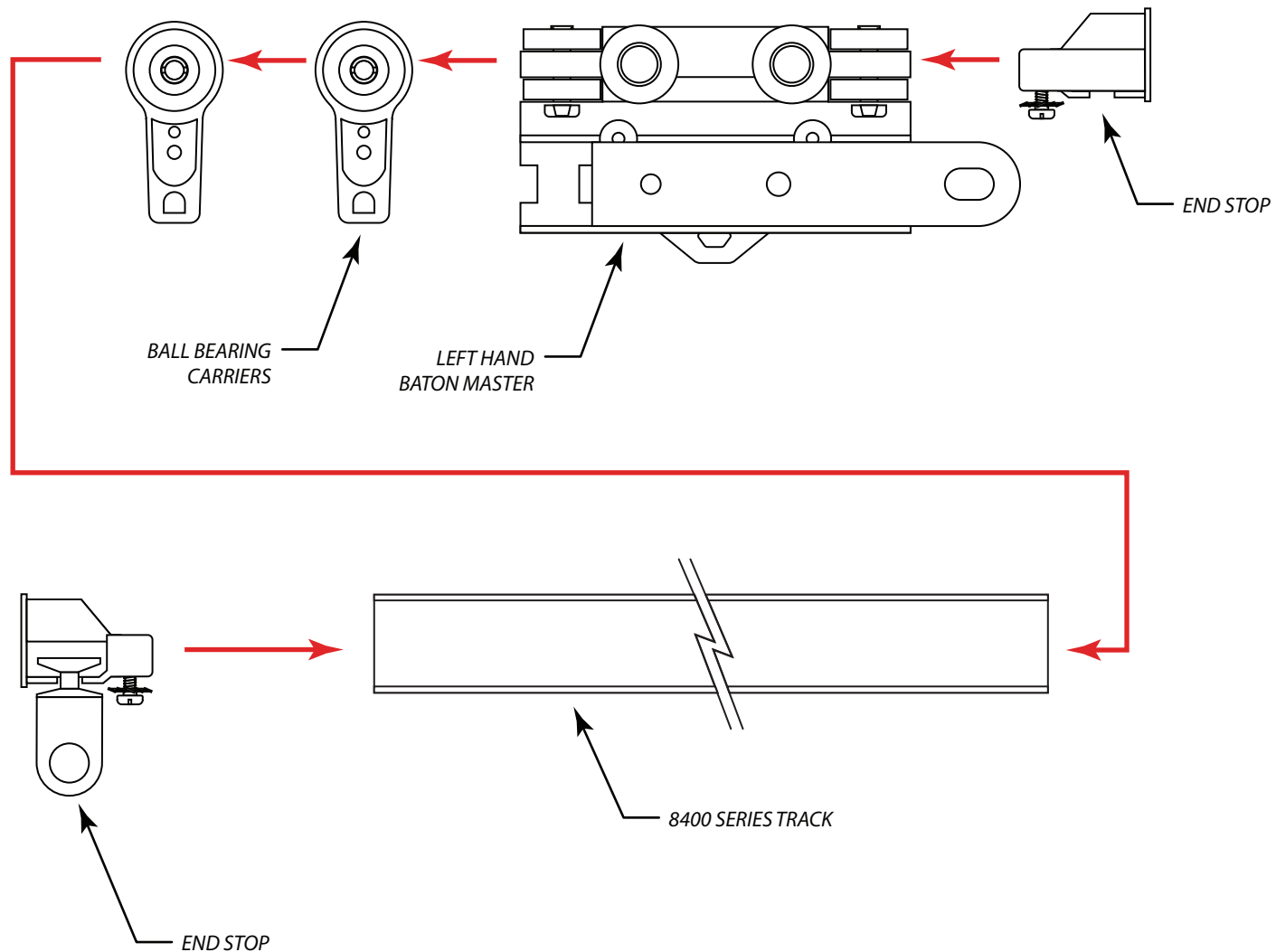

CONFIDENTIAL All materials disclosed in this document are proprietary to Diamond Drapery Co., Inc. The Holder agrees to maintain it in confidence and must not replicate or reveal this information in any manner.	Project: 8400 Series Drapery Tracking System Pinch Pleat, Left Hand Panel	
	Date: 22-DEC-2008	Dimensions: Inches/Feet
	Scale: DO NOT SCALE	By: C. Johnson



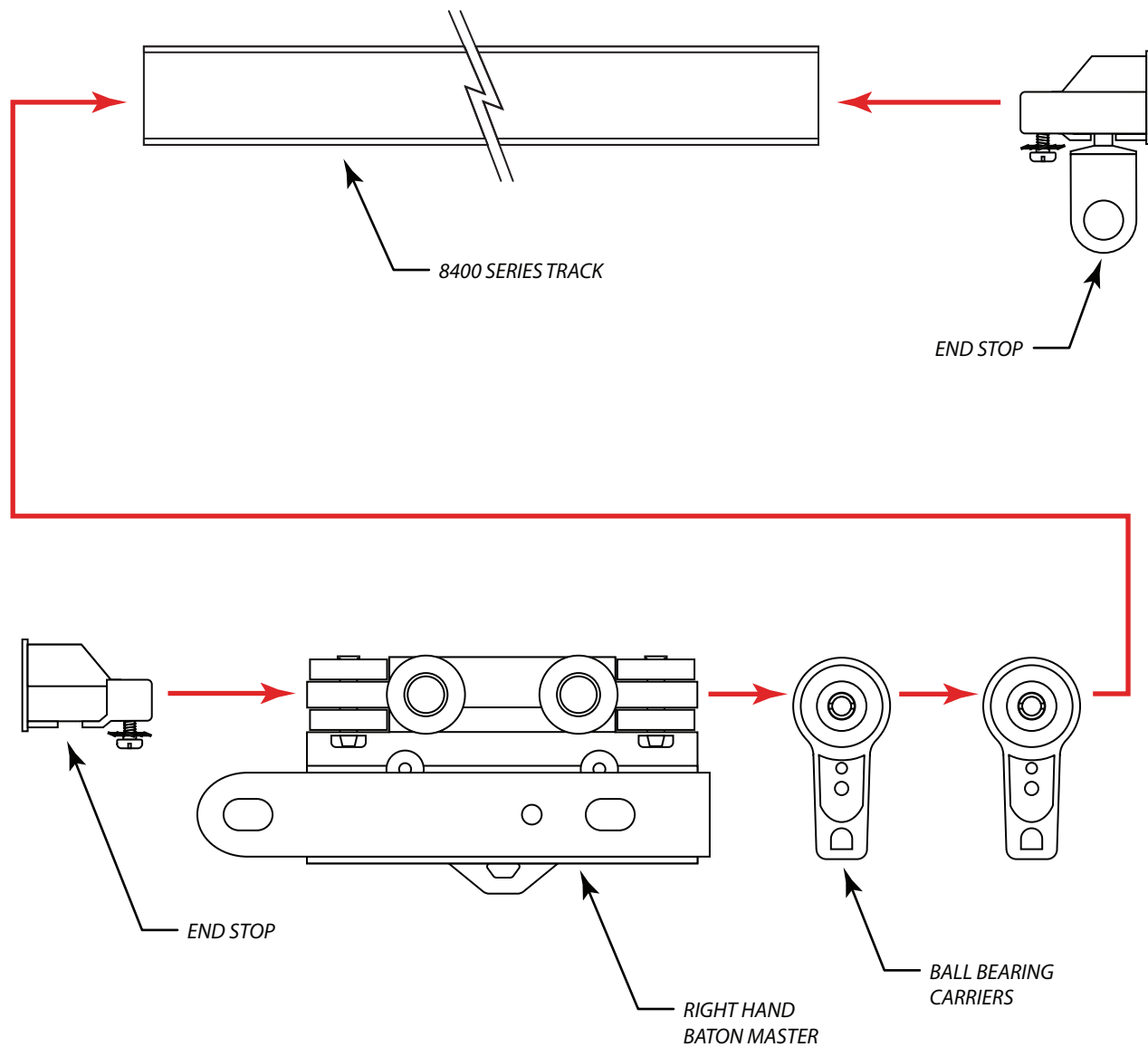

CONFIDENTIAL All materials disclosed in this document are proprietary to Diamond Drapery Co., Inc. The Holder agrees to maintain it in confidence and must not replicate or reveal this information in any manner.	Project: 8400 Series Drapery Tracking System Pinch Pleat, Right Hand Panel	
	Date: 17-DEC-2008	Dimensions: Inches/Feet
	Scale: DO NOT SCALE	By: C. Johnson

