

# DRAPERY TRACKING AND PARTS DESCRIPTIONS

## 8100 SERIES

### GENERAL DESCRIPTIONS

#### 8100 Drapery Track

Drapery track system shall be Diamond Drapery Model Number 8300 complete with 1.5" x 1.0625" extruded aluminum track channel, carriers, end caps, and other required accessories for a complete and operational track system. Draperies are cord drawn. The 8100 track may be wall or ceiling mounted. The 8100 track is extruded of .050" 6063-T5 Aluminum alloy with white baked enamel. Track channel available in straight continuous lengths up to 18 feet. It is shown here with a ball bearing carrier and drapery pin hook.

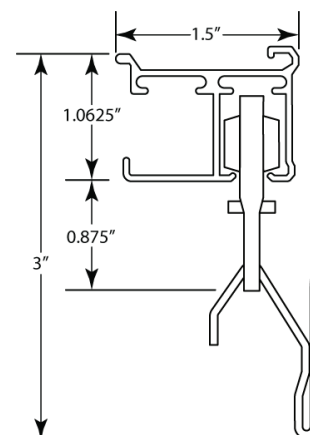

### COMPONENT DESCRIPTIONS

#### 8100-01 Snap Tab Carrier

Snap tab carrier shall be constructed of a molded white plastic body for curtain attachment. These carriers are used only for Accordia-Fold or snap pleated draperies.



#### 8100-01RF Ripple-Fold Snap Tab Carrier

Snap tab carrier shall be constructed of a molded white plastic body and be individually connected together with nylon strings for curtain attachment. These carriers are used only for Ripple-Fold draperies and are available in 60%, 80% 100% and 120% fullness levels.

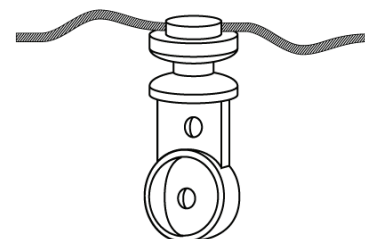

#### 8100-02 Friction Slide

Carrier shall be constructed of molded plastic body with molded in loop for French pleated or pinch pleated drapery attachment.



#### 8100-03 Ball Bearing Carrier

Carrier shall be constructed of molded white plastic body. Center of the carrier rotates and provides smooth trouble free glide. Two size carriers are offered in both 3/4" and 1" in diameter. This carrier is used primarily for French pleated or pinch pleated draperies.



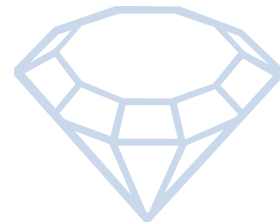

# DRAPERY TRACKING AND PARTS DESCRIPTIONS

## 8100 SERIES

### COMPONENT DESCRIPTIONS (CONTINUED)

#### **8100-32FS & 8100-32ST Right Hand Ball Bearing Pulley**

Pulley shall be constructed of white plastic with two internal ball bearing pulleys to assist the cord draw function. Used on the stacking side of the rod, carriers are snapped into the end cap to secure one end of the drapery in place. FS End Caps have friction slide carriers for Pinch Pleated draperies. ST End Caps have snap tab carriers for Ripple-Fold and Accordia-Fold draperies.

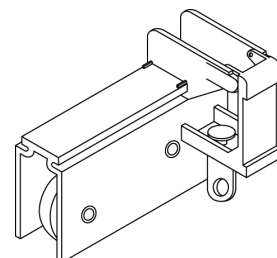

#### **8100-33FS & 8100-33ST Left Hand Ball Bearing Pulley**

Pulley shall be constructed of white plastic with two internal ball bearing pulleys to assist the cord draw function. Used on the stacking side of the rod, carriers are snapped into the end cap to secure one end of the drapery in place. FS End Caps have friction slide carriers for Pinch Pleated draperies. ST End Caps have snap tab carriers for Ripple-Fold and Accordia-Fold draperies.

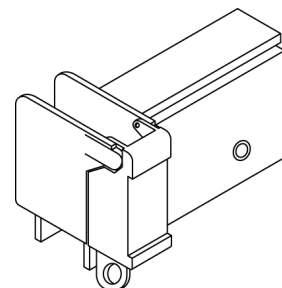

#### **8100-34 Right Side One-Way Draw Pulley**

Pulley shall be constructed of white plastic with two internal ball bearing pulleys to assist the cord draw function. Used only on one-way (panel) draw tracks, the pulley is located opposite of the stacking side of the rod.

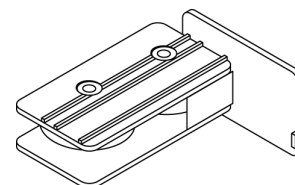

#### **8100-35 Left Side One-Way Draw Pulley**

Pulley shall be constructed of white plastic with two internal ball bearing pulleys to assist the cord draw function. Used only on one-way (panel) draw tracks, the pulley is located opposite of the stacking side of the rod.

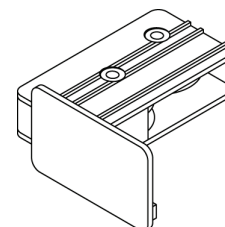

#### **8100-36 Double Panel Intermediate Pulley**

Pulley shall be constructed of clear plastic with four internal ball bearing pulleys to assist the cord draw function. Used only center open draperies, the Intermediate Pulley allows each side of the pair to operate individually while retaining the look of a true center opening pair.

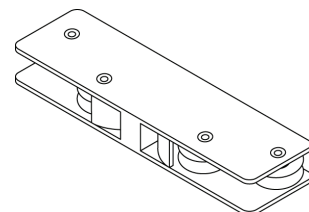

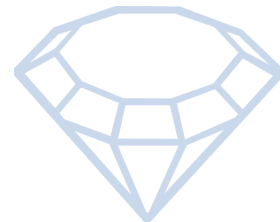

# DRAPERY TRACKING AND PARTS DESCRIPTIONS

## 8100 SERIES

### COMPONENT DESCRIPTIONS (CONTINUED)

#### **8100-37 Right Hand Snap Pleat Master Carrier**

The snap pleated master carrier shall be constructed from a white plastic body. This master carrier shall be used as the master carrier for Accordia-Fold, Ripple-Fold, or snap pleated draperies.

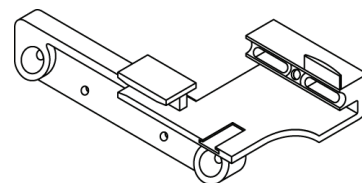

#### **8100-38 Left Hand Snap Pleat Master Carrier**

The snap pleated master carrier shall be constructed from a white plastic body. This master carrier shall be used as the master carrier for Accordia-Fold, Ripple-Fold, or snap pleated draperies.

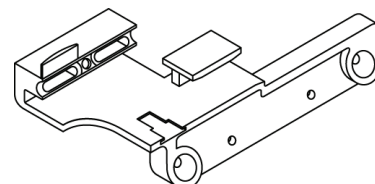

#### **8100-39 Right Hand Master Carrier**

This drapery master carrier shall be constructed from a molded white plastic body. Eight molded  $\frac{1}{2}$ " diameter wheels cause the master carrier to slide inside the track channel. A 3" heavy duty steel master carrier arm serves as the furthestmost edge of the drapery carrier. This master carrier is used for French pleated and pinch pleated draperies.

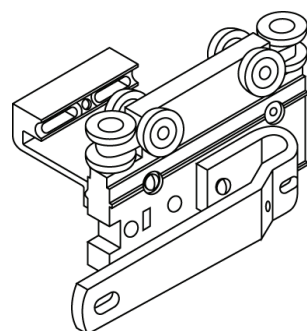

#### **8100-40 Left Hand Master Carrier**

This drapery master carrier shall be constructed from a molded white plastic body. Six molded  $\frac{1}{2}$ " diameter wheels cause the master carrier to slide inside the track channel. A 3" heavy duty steel master carrier arm serves as the furthestmost edge of the drapery carrier. A fiberglass baton attaches to the base of this master carrier. This master carrier is used for French pleated and pinch pleated draperies.

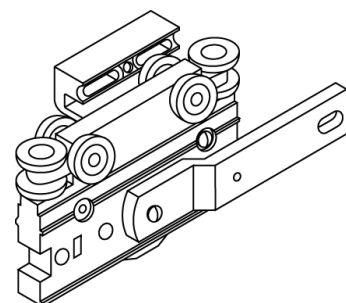

#### **8100-41 Right Hand Ripple-Fold Butt Master Carrier**

The ripple-fold butt master carrier shall be constructed from a white plastic body. This master carrier shall be used as the master carrier for Ripple-Fold draperies only.

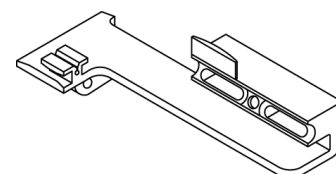

#### **8100-42 Left Hand Ripple-Fold Butt Master Carrier**

The ripple-fold butt master carrier shall be constructed from a white plastic body. This master carrier shall be used as the master carrier for Ripple-Fold draperies only.

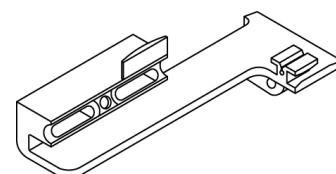

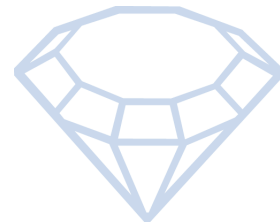

# DRAPERY TRACKING AND PARTS DESCRIPTIONS

## 8100 SERIES

### COMPONENT DESCRIPTIONS (CONTINUED)

#### **8100-43 Ripple-Fold Overlap Master Adapter**

This ripple-fold overlap master adapter shall be constructed from a molded white plastic body. It is used to attach ripple-fold carriers to the snap tab master carrier.

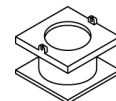

#### **8100-44 Track Clip**

Made of heavy gauge steel, the track clip assembly is designed to allow quick and easy installation of track utilizing the notches at the top of the 8100 series track.

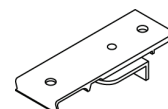

#### **8100-45 Wall Bracket, 6"**

Made of heavy gauge aluminum and combined with a track clip assembly, this wall bracket is designed with a 6" clearance to allow easy installation of two sets of track and curtains. The track clip secures the track into place utilizing the notches at the top of the 8100 series track.

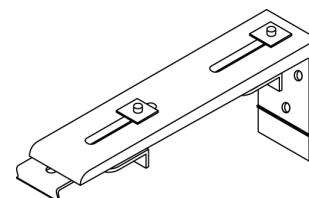

#### **8100-46 Wall Bracket, 3"**

Made of heavy gauge steel and combined with a track clip assembly, this wall bracket is designed with a 3" clearance to allow easy installation of track and curtains. The track clip secures the track into place utilizing the notches at the top of the 8100 series track.

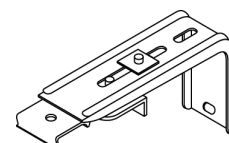

#### **8100-47 Splice**

Made of heavy gauge aluminum this splice is designed to securely attach two pieces of track together utilizing the notches at the top of the 8300 series track.

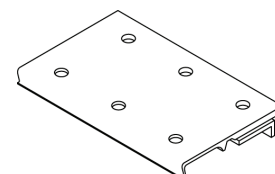

#### **8100-48 Cord Tension Pulley**

Constructed of a heavy duty spring with a ball bearing pulley assembly at the end, the cord tension pulley is designed to hold the draw cord in place on the wall.

