

Gravity Lock Carrier
7000-09

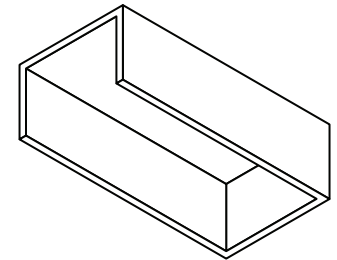

End Stop
7000-03

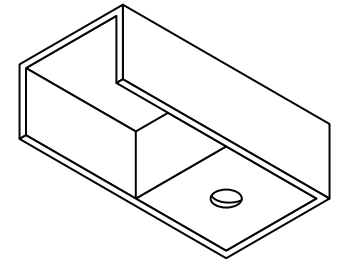

End Stop with Pull-Out
7000-04

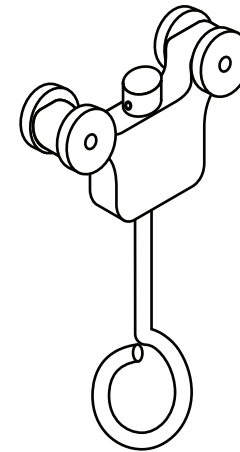

Twist Lock Carrier
7000-19

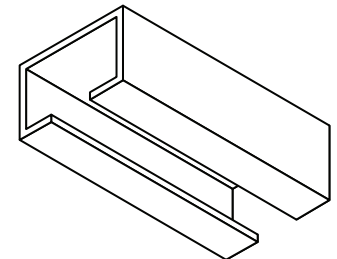

Splice
7000-05

I.V. Track:

Diamond Drapery 7000 Series
Clear Anodized Aluminum

Carrier:

Diamond Drapery 7000-09 Gravity Lock I.V. Tree Carrier
or Diamond Drapery 7000-19 Twist Lock I.V. Tree Carrier

Other Parts:

Diamond Drapery endcap, endcap with pull-out, and splice. All
clear anodized aluminum parts.

CONFIDENTIAL All materials disclosed in this document are proprietary to Diamond Drapery Co., Inc. The Holder agrees to maintain it in confidence and must not replicate or reveal this information in any manner.	Project: 7000 Series I.V.Tracking System	
	Date: 24-MAR-2009	Dimensions: Inches/Feet
	Scale: DO NOT SCALE	By: C. Johnson



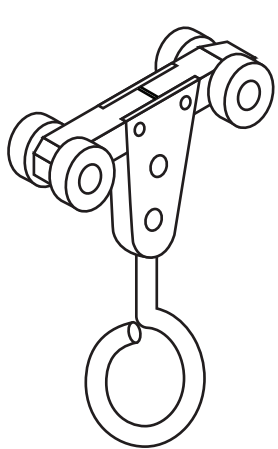

Gravity Lock Carrier
7000-09

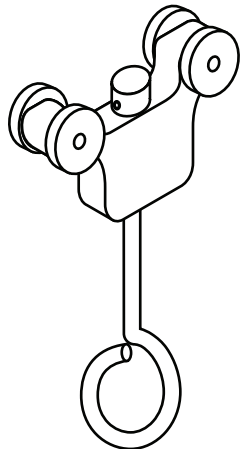

Twist Lock Carrier
7000-19

OPTIONAL

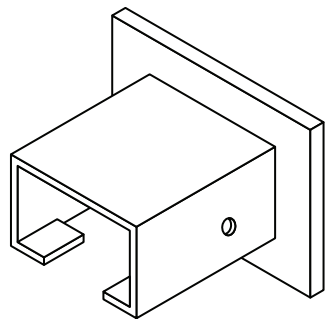

Track End Wall Bracket
7000-07

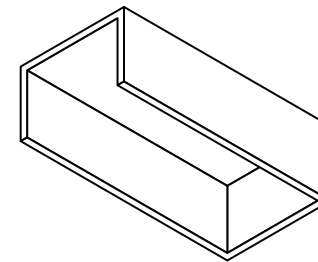
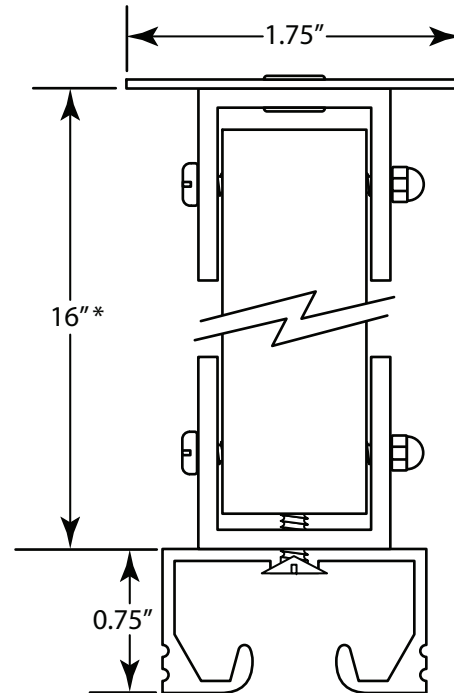

End Stop
7000-03

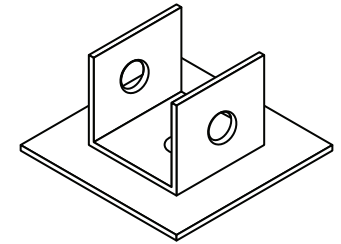

Ceiling Bracket
7000-06

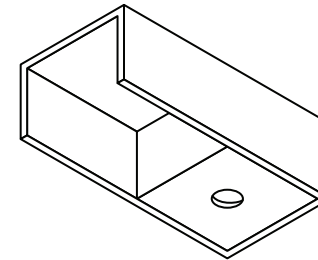

End Stop with Pull-Out
7000-04

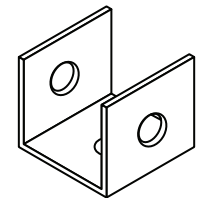

Track Bracket
7000-08

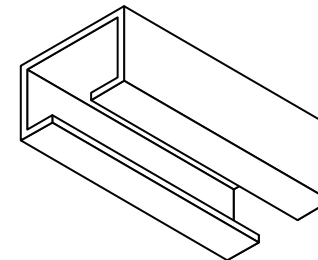

Splice
7000-05

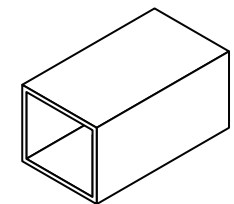

Suspension Tubing
7000-ST

Cubicle Track:

Diamond Drapery 7000 Series
Clear Anodized Aluminum

Carrier:

Diamond Drapery 7000-09 Gravity Lock I.V.Tree Carrier
or Diamond Drapery 7000-19 Twist Lock I.V.Tree Carrier

Other Parts:

Diamond Drapery end stop, end stop with pull-out, splice, ceiling bracket,
track bracket, and suspension tubing. All clear anodized aluminum parts.

* Suggested suspension length. Distance may vary due to site conditions.

CONFIDENTIAL

All materials disclosed in this document are proprietary to Diamond Drapery Co., Inc. The Holder agrees to maintain it in confidence and must not replicate or reveal this information in any manner.

Project:

7000 Series Suspended I.V.Tracking System

Date:

24-MAR-2009

Dimensions:

Inches/Feet

Scale:

DO NOT SCALE

By:

C. Johnson



7439 Lampson Avenue
Garden Grove, CA 92841
(714) 761-4543 OFFICE (714) 761-4623 FAX