

I.V. TRACKING AND PARTS DESCRIPTIONS

7000 SERIES

GENERAL DESCRIPTIONS

I.V. Track

I.V. track system shall be Diamond Drapery Model Number 7000 which is equivalent to Kirsch 7900 complete with 1-1/8" x 3/4". 7000 Series cubicle track is extruded aluminum track channel, 6063-T5 with carriers, end stops, and other required accessories for a complete and operational track system. Inner surface is center ridged grooved for easy installation. If specified, tracks will be bent or circular curved for one continuous length up to 20 feet. Bends will have an approximate 12 inch (308mm) radius.

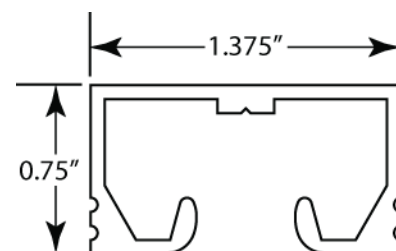

COMPONENT DESCRIPTIONS

7000-03 End Stop

End stop of .032" minimum sheet aluminum die-formed with commercial clear anodized finish.

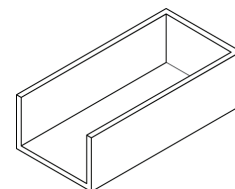

7000-04 End Stop with Pull-Out

End stops of .032" minimum sheet aluminum die-formed with commercial clear anodized finish. Pull-out of .032" minimum sheet aluminum die-formed and anodized with commercial clear finish. Plated machine screw permits removal of pull-out for access to track carriers.

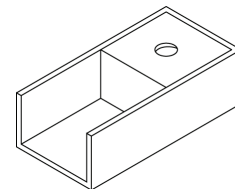

7000-05 Splice

Splice shall be made from extruded 6063-T5 aluminum with commercial clear anodized finish.

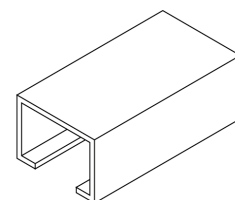

7000-06 Ceiling Bracket (for Suspension Mount)

Ceiling bracket constructed of sheet aluminum top and extruded 6063-T5 "U" channel. All aluminum parts have a commercial clear anodized finish.

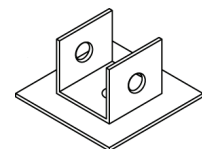

7000-07 Track End Wall Bracket (for Suspension Mount)

Wall bracket shall be made from extruded steel alloy aluminum with a powder coated finish.

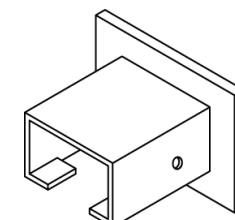

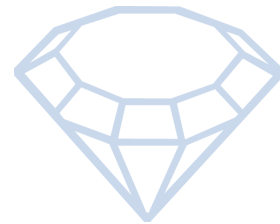

I.V. TRACKING AND PARTS DESCRIPTIONS

7000 SERIES

COMPONENT DESCRIPTIONS (CONTINUED)

7000-08 Track Bracket (for Suspension Mount)

Track bracket shall be made from extruded 6063-T5 aluminum with commercial clear anodized finish.

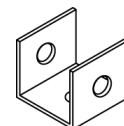

7000-09 I.V. Tree Gravity Locking Carrier

I.V. gravity lock carrier has a body which is rustproof, die cast aluminum. Steel alloy wheels provide four point suspension system. Stainless steel spiral safety hook is attached to carrier; weight of first bottle automatically locks carrier to 7000 series track.

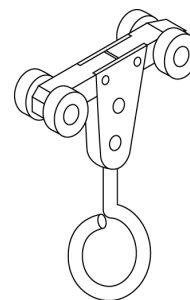

7000-10ADJ I.V. Tree Deluxe Adjustable 26" – 42" – 5 Bottles

Main shaft is $\frac{3}{4}$ " polished stainless steel; inner shaft, $\frac{3}{8}$ " polished stainless steel; spiral safety arms, $\frac{1}{4}$ " stainless steel. Body, lower release knob, upper body lock and inner center rod guide bushing of high quality molded Celcon. Tree adjusts from 26" to 42" multiple arm body moves up or down on tube to increase or decrease gravitation flow; locks are spring loaded. Tree supports up to five I.V. bottles; spiral safety arms fold for storage. Eye at top is coated with an insulating material for non-conductivity between tree and carrier.

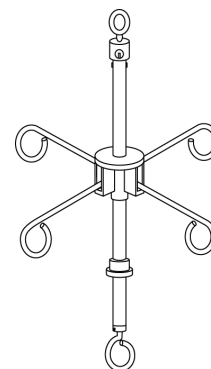

7000-19 I.V. Tree Twist Lock Carrier

Twist lock carrier has a body which is rustproof, die cast aluminum. Nylon wheels provide four point suspension. Stainless steel spiral safety hook is attached to carrier; twist the safety hook to lock carrier to 7000 series track.

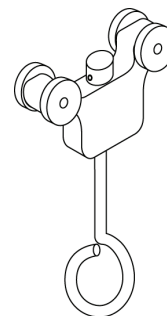

7000-ST Suspension Tubing

Suspension tubing shall be made from $\frac{3}{4}$ " x $\frac{3}{4}$ " x .063" extruded 6063-T5 aluminum with commercial clear anodized finish.

